

Optical Transmit / Receive Components

Features

- Customized thickness and production are available
- Excellent stability, flexibility and versatility
- Storage Temperature Range: -40°C~+85°C
- Both SC and LC receptacle are available

ROSA LC Receptacle



TOSA Receptacle

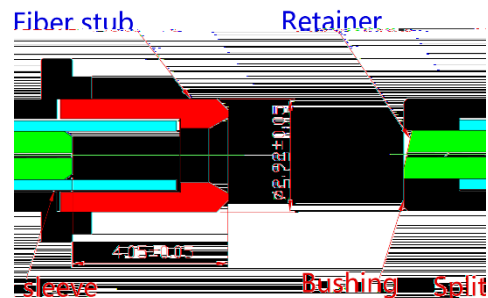
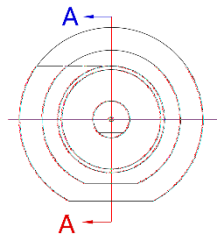

Specification

Stub Concentricity	(μm)	≤ 0.7
Insertion Loss	(dB)	≤ 0.2
Return Loss	(dB)	≥ 45
Substrate		Ceramic
Bushing		SUS 316F
Retainer		SUS 316F
Wiggle Test		IEC 62150-3-2012